

## 1 General Introduction

GK cabinet a/c series is a new product series developed based on the international advanced experience and it is developed after a considerable improvement in its structure, assembly workmanship and use of elements. GK cabinet a/c series has about 200 types such as W I 、 W II 、 W III 、 WIV 、 L I 、 L II 、 L III 、 LIV 、 LM and DX I 、 DX II 、 DYA、 DYM with the airflow range 1000~45000m<sup>3</sup>/h in order to meet different requirements of temperature and humidity under variable climate conditions. Also the control device for temperature and humidity and frequency control unit can be installed upon request. The product series has its features as small volume, light weight and easy to be installed on the spot. The unit can also be installed above the ceiling to save space to meet the requirement of big area.

Due to low noise design, the product can be widely used in the HVAC works in hospitals, hotels theatres, office buildings, factories and other large public facilities etc.

## 2 Symbol Explanation

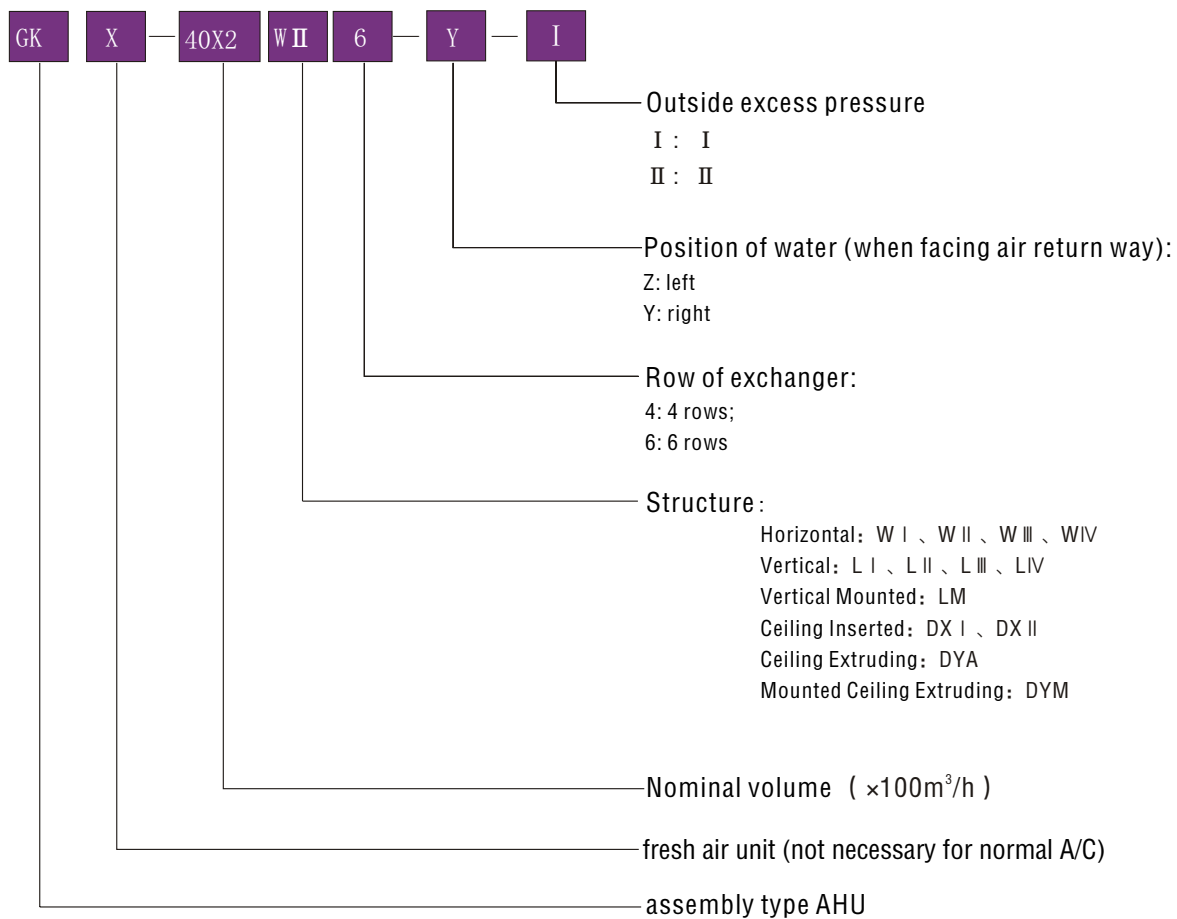

Example: GKX-40×2 WII 6-y-I represents cabinet a/c unit, with two air units whose volume is 8000m<sup>3</sup>/h, exchanger being 6-row horizontal blowing downward, pipe at right side, outside excess pressure being category I (or 350Pa).

3 Characteristics

Vertical Mounted  
Structure: LM



- The unit is designed as structure compact, good looking, noise damper, light weight.
- It is an economical type due to the air being sent out directly without duct.
- The air outlet grille can be adjusted so that the angle of air outlet can be adjusted accordingly.
- The front plate can be dismantled for cleaning and maintenance purposes.
- The high-effective nylon plate filter is specially installed so that it can be dismantled for cleaning without any special tools.
- The tray for collecting condensed water is made of stainless steel so the problem of being rusted can be avoided.

4 Dimension Drawing

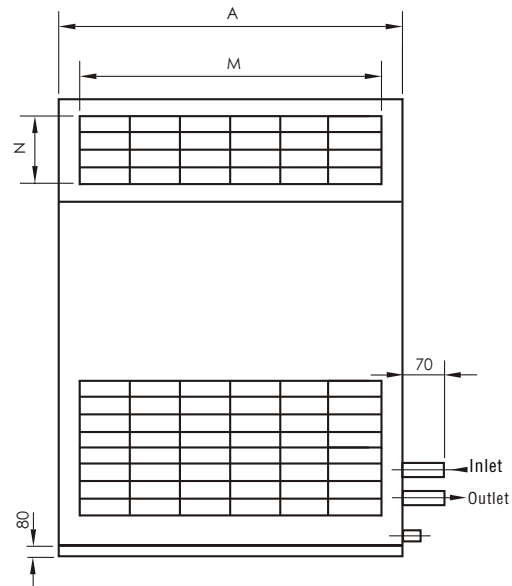
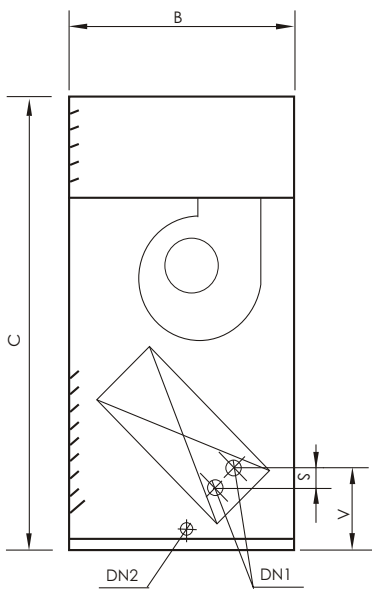

5 Dimension Form for Vertical Mounted Cabinet A/C

Unit: mm

Specs		A	B	C	M	N	V	S	DN1	DN2
20	4 rows	730	500	2000	630	230	185	~53	32	20
	6 rows		580					~83		
20X2	4 rows	1240	500	2000	1140	230	185	~53	40	20
	6 rows		580					~83		
25	4 rows	780	500	2000	680	230	185	~53	32	20
	6 rows		580					~83		
25X2	4 rows	1340	500	2000	1240	230	185	~53	40	20
	6 rows		580					~83		
30	4 rows	780	600	2150	680	270	185	~53	32	20
	6 rows		680					~83		
30X2	4 rows	1340	600	2150	1240	270	185	~53	40	25
	6 rows		680					~83		
35	4 rows	840	650	2220	740	300	190	~53	40	20
	6 rows		730					~83		
35X2	4 rows	1450	650	2220	1350	300	190	~53	50	25
	6 rows		730					~83		
40	4 rows	840	650	2220	740	330	200	~53	40	20
	6 rows		730					~83		
40X2	4 rows	1450	650	2220	1350	330	200	~53	50	25
	6 rows		730					~83		
50	4 rows	940	700	2220	790	330	200	~53	40	20
	6 rows		780					~83		
50X2	4 rows	1650	700	2220	1450	330	200	~53	50	25
	6 rows		780					~83		

Parameter Form for Vertical Mounted Cabinet A/C

Specs		Rated air volume m <sup>3</sup> /h	Rated cooling capacity(kW)	Rated Heat (kW)	Fan pow(kW)	Cooling Water Volume( m <sup>3</sup> /h)	Cooling Water Resistance (kPa)	Noised B(A)	Weight
20	4 rows	2000	11.15	13.4	0.25	1.92	1.8	57	245
	6 rows		14.5			2.49	3.96		290
20×2	4 rows	4000	22.3	26.8	0.25×2	3.84	4.23	60	410
	6 rows		29			4.99	9.31		500
25	4 rows	2500	13.94	16.74	0.25	2.4	2.64	57	275
	6 rows		18.12			3.18	5.81		320
25×2	4 rows	5000	27.88	33.48	0.25×2	4.8	4.96	60	460
	6 rows		36.24			6.23	10.91		555
30	4 rows	3000	16.7	20.09	0.37	2.87	3.22	57	290
	6 rows		21.71			3.73	7.08		350
30×2	4 rows	6000	33.4	40.18	0.37×2	5.76	5.25	60	515
	6 rows		43.42			7.49	11.55		640
35	4 rows	3500	19.5	23.44	0.55	3.35	3.62	57	315
	6 rows		25.35			4.36	7.96		385
35×2	4 rows	7000	39	46.88	0.55×2	6.71	6.09	60	540
	6 rows		50.7			8.72	13.4		670
40	4 rows	4000	22.3	26.8	0.55	3.84	3.98	59	340
	6 rows		28.29			4.99	8.76		415
40×2	4 rows	8000	44.6	53.6	0.55×2	7.67	6.21	62	555
	6 rows		57.58			9.97	13.66		690
45	4 rows	4500	25.1	30.14	0.55	4.32	4.24	60	360
	6 rows		32.6			5.61	9.33		440
45×2	4 rows	9000	50.2	60.28	0.55×2	8.63	8.42	63	600
	6 rows		65.3			11.22	18.52		740
50	4 rows	5000	27.88	33.49	0.8	4.8	4.66	63	330
	6 rows		36.3			6.25	10.25		470
50×2	4 rows	10000	55.76	68.98	0.8×2	9.59	8.85	66	650
	6 rows		72.5			12.47	19.47		800

## 8 Selection Reference

- 1, Units with the same air volume are different in other features, such as the installation space, air pressure and noise. For example, the air volume of GK-40 and GK-20×2 both is 4000m<sup>3</sup>/h, but GK-20×2 has a lower noise, less air pressure, bigger width and smaller height.
- 2, The temperature of refrigerant water shall be no less than 5℃; and the temperature of heating water shall be no higher than 60 5℃.
- 3, The water In/out duct shall be equipped with stop valve as well as thermometer, pressure meter and water filter. If necessary, balanced valve is required.
- 5, We can provide non-standard design if required.

## 9 Technical Parameters Explanation

- 1, The rated refrigerated output and heating output is calculated under the nominal working conditions, just for customer's reference.
- 2, Cool water temperature: supplying water 7℃; return water 12℃.  
hot water temperature: supplying water 55℃; return water 45℃.
- 3, Normal A/C in the form refers to: the temperature of inlet dry ball is 27℃, temperature of wet ball is 19.5℃ in cooling; the temperature of inlet dry ball is 20℃ in heating.
- 4, New air unit in the form refers to : the temperature of inlet dry ball is 34℃, temperature of wet ball is 28℃ in cooling; the temperature of inlet dry ball is -4℃ in heating.

## 10 About Installation

- 1, GK series features smooth running and low vibration. Vibration absorbing base is necessary if high vibration attenuation is required.
- 2, The in/out duct of A/C unit is usually that the inlet duct is at the downside and the outlet duct is at the upside (vertical mounted units excluded). The condensed water outlet duct shall be at the lowest point. Valves shall be installed at the outside for in/out ducts for the maintenance and adjustment of flux. In consideration of negative pressure, water lock is necessary for the condensed water duct.
- 3, Air duct and water duct connected to the A/C units shall be supported separately from the units.
- 4, Before supply water, it is important to ensure the system free of any dirt. This is to guarantee the exchange efficiency.
- 5, Before the initial start-up, check the wiring connections, grounding condition and if there are any remaining dirt. When everything is ready, start the fan and check the rotation direction.
- 6, Heat preservation shall be applied to the joint part of air outlet and air duct.
- 7, Heat preservation shall be extended to the side panel of the units.

## 11 About Maintenance

- 1, Start the fan and pump, and the unit will run. Release the gas if necessary.
- 2, In idle time, the unit shall be filled with water to avoid erosion. In winter, certain anti-frost crack measures shall be applied.
- 3, In winter, the temperature of applying hot water shall be no less than 60℃; and the temperature of the blowing air shall be no less than 40℃.
- 4, The air filter shall be cleaned or replaced periodically.
- 5, Apply full-range maintenance after running for two years. Use appropriate chemicals to clean the heat exchanger. The supplier may provide charged services.
- 6, Check the wiring connection, protection devices and the grounding to remove all potential dangers.

## 12 About Order

- 1, Customers shall specify the detailed type, specification and working conditions of the A/C units.
- 2, The location of inlet duct, outlet duct and condensed water duct shall be specified.
- 3, Electric control box shall be ordered separately in required.
- 4, We provide non-standard products to your special requirements.